

PLAMERE™

Esthetic Multi-Plasma Device

Acne ▪ Lifting ▪ Permeating ▪ Fractional

INSTRUCTION MANUAL

PLAMERE™
Esthetic Multi-Plasma Device

Plasma
Fractional



Plasma
Lifting



Plasma
Permeating



INSTRUCTION MANUAL

English

PLAMERE™
Esthetic Multi-Plasma Device

INSTRUCTION MANUAL

For safe use, please read this manual carefully.
Use it correctly according to the contents described.
Keep this book for future use to transferring this
Product to another person, please be sure to deliver it together.



C O N T E N T S

INSTRUCTION 05
CAUTION 06
PRODUCT COMPOSITION 07
DESIGNATION 08
HOW TO USE 09
HOW TO CHARGE 14
SPECIFICATION 15
PRODUCT WARRANTY 15

INSTRUCTION

■ Patent Plasma Acne Care Tips

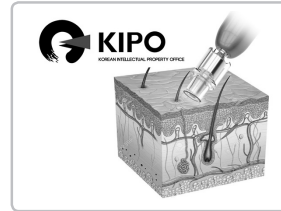

- Plasma tips dedicated to acne that suppress excessive ozone and ultraviolet radiation and provide the right amount of radicals and UV for acne treatments.
- Safe use due to hygienic management and overheating effect by adopting exchangeable dedicated film.

■ Pulse Mode Plasma Lifting

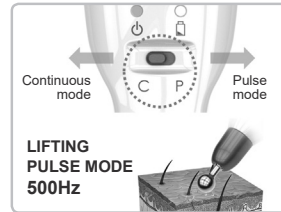

- Support pulse mode of 500Hz as well as continuous mode.
- Plasma treatment by pulse mode which optimized for lifting promotes collagen synthesis and wrinkles.

■ Base-offer plasma permeating tips and fractional tips for cosmetic applications

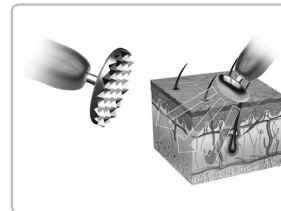

- 40kHz Continuous mode permeating tips with electroporation effect.
- Fractional tips which use together with Permeating tips to maximize permeating effect.

CAUTION

- Do not use or leave it near fire, pay attention of the risk of volatile gas ignition.
- Do not disassemble or modify the product.
- Do not touch or handle the body and charger with wet hands.
- When attaching the needle to the syringe mounted on the body, be careful not to get stung or damage the needle.
- Always wipe the body and components with a dry cloth before and after use to keep the condition as hygienic status.
- Exclusive film of acne tips are disposable and should never be reused.
- Please check the charging status before use and use it after fully charge.
- If you move from a cool outside to a warm inside, sudden changes in temperature can cause condensation that can form water droplets. In this case, please adjust the temperature for a sufficient time indoors and use after the condensation does not occur or disappear.
- Do not operate the tips against metal or metal objects. There is a risk of malfunction or damage.
- Do not use more than few seconds in one place during the procedure. There are risk of skin damage if energy is concentrated too much in one place.
- Do not use excessive force on the buttons, motor, and charging terminals of the product. It may cause damage or breakdown.
- If the product is dropped or damaged by an external shock, do not use it, only the case of operating well before use.
- Never wash with water. Warranty does not apply in case of failure due to flooding.
- During the procedure of plasma operation at the time of start and break, the electric field may intermittently increase. Please do not use it near other electronic devices.
- Pregnant and breastfeeding women are prohibited to use.
- Do not use other than the skin surface(mucous membranes and mucus areas, nose, mouth, genitalia, etc)
- Prohibited : Patients with hepatitis C virus and infection, patients with immune system disorders(heart, liver, kidney failure), HIV/AIDS patients, local anesthesia allergy patients, heart pacemakers or active.

PRODUCT COMPOSITION

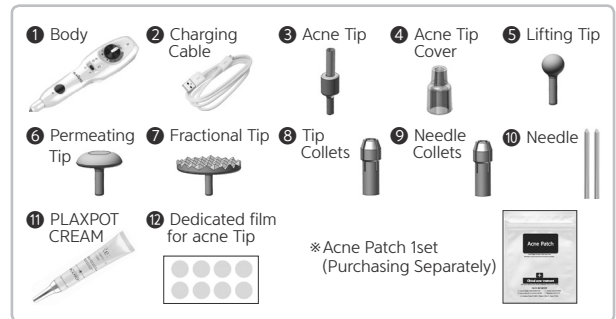

■ Components name & Function

- 1 Body**
Main body for Plasma Output. To applied various tips, the 3Ø standard collet has set up as base.
 - 2 Charging Cable**
Charging Lithium polymer battery by USB Charging cable.
 - 3 Acne Tip**
Tip for acne procedures.
 - 4 Acne Tip Cover**
This is a cover for attaching and fixing the special film to the acne tip.
 - 5 Lifting Tip**
Ball-shaped tip for lifting procedures.
 - 6 Permeating Tip**
Tip used to promote cosmetic absorption.
 - 7 Fractional Tip**
Tips used to supplementary for cosmetic absorption.
 - 8 Tip Collets**
Use to fix the tip.
 - 9 Needle Collets**
Use to fix the needle.
 - 10 Needle**
This needle is used for the treatment with Plasma Arc.
 - 11 PLAXPOT CREAM**
Apply evenly to sensitive skin after the procedure.
 - 12 Dedicated film for acne Tip**
Disposable film to be attached to the tip in the acne procedure.
- * Acne Patch : Patch used for acne treatment. The ingredients has applied to improve acne.

DESIGNATION

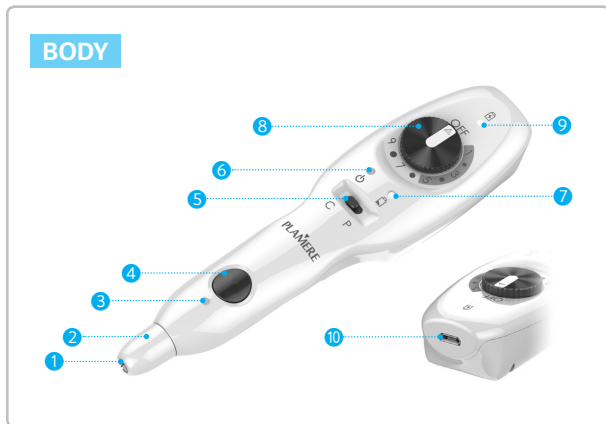

1 Collet

A part for inserting the needle tip as 3Φ standard size.

2 Head Cap

Cap for fixing needle tip.

3 Output Indicator

Indicates the state of plasma output.

4 Shot Button

Operating button for plasma output.

5 Mode Selection Switch

Continuous (C) or Pulse (P) mode.

If pulse mode selected, it will be output in pulse form of 500Hz.

■ When using the pulse mode, set the wheel switch 5 or less.

6 Power Indicator

Indicates Power ON/OFF status.

7 Battery Warning Light

Red is displayed when the remaining battery is low.

■ If the warning light comes on, stop using it and charge it before using it.

8 Wheel Switch

Turn ON/OFF the power or adjust the plasma output intensity.

9 Charging Indicator

Indicates charging status. (Red: charging, Green : charging completed)

10 Charging Terminal

Terminal for connecting a micro USB type charger.

■ Pressing the shot button doesn't work during charging.

HOW TO USE | PART 1 : Acne Tip + Dedicated Film

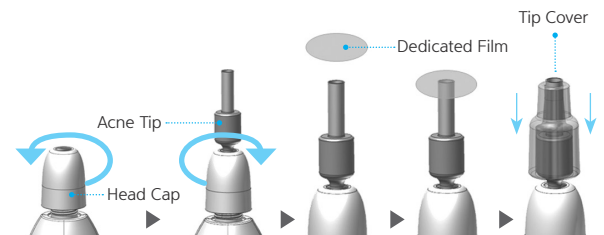

1 Tip Installation

- Rotate the head cap counterclockwise to loosen it slightly, insert the acne tip into the collet, and turn the head cap clockwise to secure the tip to the collet.

2 Attaching the dedicated film and tip cover

- Remove one film for acne tip, attach the adhesive side of the film to the top of the acne tip and cover the tip cover.

⚠ CAUTION

▶ When attaching the film and cover the tip cover, push it deep enough to expose the tip over the cover as shown below. Plasma is generated when the ring part of the tip which attached film is in contact with the skin.



3 Procedure

- Set the Continuous(C) mode and intensity to 7~9. Slowly move the tip as circle while press the shot button while touching the acne area.
- When attach to the skin, a ring-shaped plasma forms at the tip of the film attached and releases adequate amount of radicals, ultraviolet(UV) and heat to help improve acne.

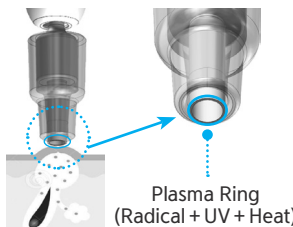

⚠ CAUTION

▶ Using the dedicated film only, in the case the film will be destroyed and sparks will be directly transferred to the skin which can damage.

▶ Dedicated fill is disposable use. Re-use may cause damage to the film.

HOW TO USE | PART 2 : Acne Tip + Acne Patch

1 Tip Installation

- Rotate the head cap counterclockwise to loosen it slightly, insert the acne tip into the collet, and turn the head cap clockwise to secure the tip to the collet.

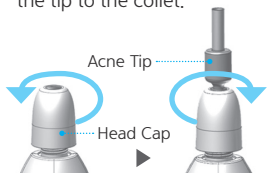

CAUTION

▶ If acne patches are used, there is no dedicated film to generated plasma. Be sure to remove the film when the dedicated film is attached to the tip.

2 Attach the Acne Patch

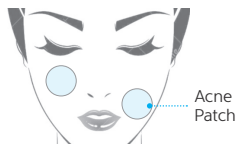

- Remove the patch and attach it to the area of the acne to perform.
- Clean the skin before applying and No toner and lotion.
- Do not use damaged patch.

3 Attach the Acne Patch

- Set the Continuous(C) mode and intensity to 7~9. Slowly move the tip as circle while press the shot button while touching the acne area.
- When attach to the skin, a ring-shaped plasma forms at the tip of the film, attached and releases adequate amount of radicals, ultraviolet(UV) and heat to help improve acne.
- Released plasma also has the effect of promoting skin absorption of the ingredients applied to the acne patch.

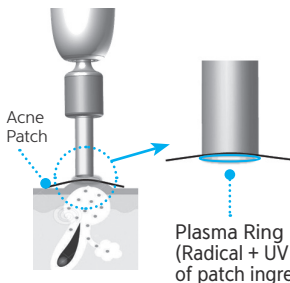

CAUTION

▶ Please be aware of not to leave the patch area, If the tip touches the skin directly, sparks maybe directed to the skin and it cause of skin damage.

HOW TO USE | PART 3 : Plasma Lifting for Wrinkle Improvement and Collagen Regeneration

1 Tip Installation

- Rotate the head cap counterclockwise to loosen it slightly, insert the lifting tip into the collet, and turn the head cap clockwise to secure the tip to the collet.

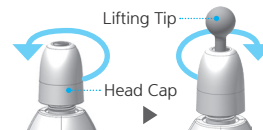

2 Procedure

- Pressing the shot button doesn't work during charging.

CAUTION

▶ When using the pulse (P) mode, use the output intensity in the range of 1~5 and do not use more than 5. Pulse mode has a frequency output of 500Hz specially designed for lifting, so over 5 cycles can cause unnecessary skin irritation.

- First, clean the skin before the procedure. During the plasma lifting procedure, there are nothing to applied to the skin. But if necessary, apply the appropriate primer, high-frequency cream, lifting cream, etc.
- Using the tapping or brushing method, plasma discharge occurs at the moment of contact with the skin. Therefore, the appropriate output level is set according to the application site and purpose to prevent unnecessary discharge.

Dragging	Tapping	Brushing
Slowly massage the wrinkles along the line.	Move vertically and tap Your skin like a dot.	Touch the skin surface like a brushing.

HOW TO USE | PART 4 : Permeating Tip for Cosmeti Absorbent + Fractional Tip

■ Tip installation is same as Lifting tip installation. The procedure, it takes 15minutes as shown below.

1 Tapping by Fractional Tip – 5min

• After installing the fractional tip first, clean the treatment are and remove the water, Set the continuous(C) mode and the output intensity to 3~5, then move the tip and tapping lightly.

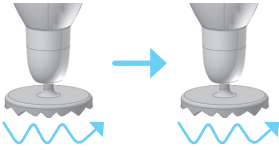

■ Plasma is generated at the multipoint part of the fractional tip and the skin layer is opened to prepare the cosmetics to absorb.

2 Apply cosmetics

• Apply cosmetics evenly.

3 1st Absorbent massage by Permeating Tip – 5min

• After replace with a permeating tip, Continuous(C) mode and the output strength 5~7, then move the tip and gently massage.

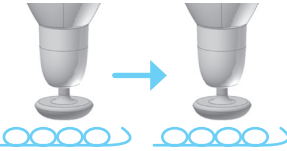

■ Plasma is generated between the permeating tip and the skin surface and the electroporation effect, cosmetic will be penetrated into the deep skin.

4 2st Absorbent massage by Permeating Tip – 5min

• After replace with a Fractional Tip, Pulse (P) mode and output strength 3~5, then move the tip and tapping lightly.

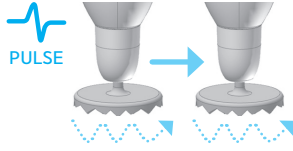

■ Plasma is generated at the multipoint part of the fractional tip and promote the absorption of residual active ingredients remaining after using the permeating tip and this is a final stage to performs skin tissue lifting by pulse.

HOW TO USE | PART 5 : Plasma Arc + Needle

1 Needle Tip Installation

• Remove the head cap by turning it counterclockwise as shown in the picture. Then attach the needle collets after remove the tip collets. Inserting Needle tip into the Needle collets and fix it by turning the head cap clockwise again.

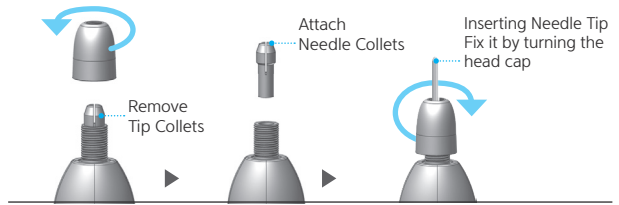

2 Operation after choosing Power Level

• Select the Continuous (C) Mode and Output Level 3~7, When the shot button is depressed, place the needle tip within 1mm of the treatment site and plasma will be output to the target site.

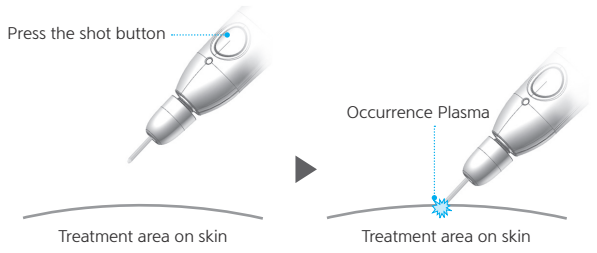

⚠ CAUTION

▶ Don't use only on place for several seconds or more. It is in danger of skin damage if the energy is focused on a place excessively.

▶ When using plasma arc, be sure to set to C(Continuous) Mode. If you use it P(Pulse) Mode, you may feel stinging.

HOW TO CHARGE

■ Connecting Micro USB

Charging starts when you Connect micro USB cable to the USB terminal of pc or notebook or connecting micro USB cable of the micro USB type mobile phone charger to the charging terminal of the main body.

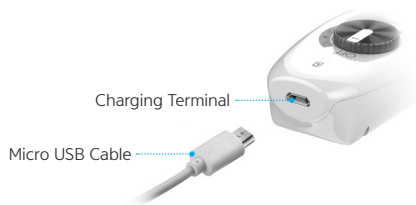

⚠ CAUTION

▶ General life of recharging battery' is 500times of recharging and discharging but it is possible to decreased depending to operation condition, temperature or moisture etc.

▶ Don't leave it for long hours without using. If you let it discharged completely, battery life will be shorten.

▶ **At your first trial, After Use it full charging.**

▶ It takes 3 hours for full charging but there is a little difference depending on remaining charge.

▶ **While charging, the shot button doesn't work. Do not use it during charging and it can't be used for user's safety.**

■ Sterilizer & Cleaning

- You may clean the used needle tip through mopping by alcohol cotton or soaking in alcohol.
- Don't soak the body into the alcohol and wipe the surface with dry cloth smoothly.

⚠ CAUTION

▶ Keep the tip after disconnecting from body after treatment. If you keep this device with tip, it will cause from damage

SPECIFICATION

■ Product Name : PLAMERE™

■ Main Function : Plasma is induced into tissues for heat, sterilization and lifting

■ Output Frequency : 40kHz

■ Output Level : Steps 1~9 (Analog wheel type)

■ Output Mode : continuous, pulse

■ Pulse Mode Frequency: 500Hz

■ Treatment Tips : Acne Tip, Lifting Tip, Permeating Tip, Fractional Tip

■ Power : Internal Li-Polymer Rechargeable Battery 3.7V, 400mAh

■ Charger : Micro USB (+5V)

■ Life Time : Full charged, Max 3hours

■ Power Consumption : Max. 2W

■ Material : Body-PC/ABS Resin

■ Weight : 100g

■ Size : 165x38x23 mm

※ Specification are subject to change without notice

PRODUCT WARRANTY

- This product is guaranteed for one year from the date of purchase.
- If it is difficult to confirm the warranty period, the warranty period will be applied from the date 15 months after the date of manufacture.
- We will repair or replace the defective product in accordance with the condition.
- Damage caused by user's negligence will not be covered by warranty even if it is within the warranty period.
- Repairs other than designated service centers are not covered by the warranty.
- The service period will not be extended after repair or repair.

Product Name	PLAMERE™	Model No.	GPM-1000
Serial No.(S/N)			
Purchasing Company			
Date of Purchasing			
Customer Info.	Name		
	Add		

※ This product is based on the Fair Trade Commission Notice of Consumer Dispute Resolution Standards Exchange or Compensation.